

ALLEGAN COUNTY ROAD COMMISSION

121ST AVENUE CULVERT REPLACEMENT 420 FEET EAST OF 36TH STREET ALLEGAN TOWNSHIP

UTILITY CONTACTS

ELECTRIC
CONSUMERS ENERGY
4000 CLAY AVE, SW
GRAND RAPIDS, MI 49548
317-445-8814
COLE ROCHOOWIAK
hamststovimp@cmsenergy.com
"MISS DIG" 811

**Board of County Road Commissioners
Of Allegan County**

1308 LINCOLN ROAD
ALLEGAN, MICHIGAN 49010-9762
TELEPHONE (269) 673-2184 www.alleganroads.org FAX (269) 673-5922

EXCEPT WHERE OTHERWISE INDICATED ON THESE PLANS OR IN THE PROPOSAL AND SUPPLEMENTAL SPECIFICATIONS CONTAINED THEREIN, ALL MATERIALS AND WORKMANSHIP SHALL BE IN ACCORDANCE WITH THE 2020 MICHIGAN DEPARTMENT OF TRANSPORTATION STANDARD SPECIFICATIONS FOR CONSTRUCTION.

THE PLACING OF PAVEMENT MARKINGS AND TRAFFIC CONTROL SIGNS SHALL BE DONE IN ACCORDANCE WITH THE 2011 MICHIGAN MANUAL OF UNIFORM TRAFFIC CONTROL DEVICES AS AMENDED.

THE IMPROVEMENTS COVERED BY THESE PLANS ARE IN ACCORDANCE WITH THE AMERICAN ASSOCIATION OF STATE HIGHWAY AND TRANSPORTATION OFFICIALS, 2011 EDITION, A POLICY ON GEOMETRIC DESIGN OF HIGHWAYS AND STREETS.

THE CONTRACTOR SHALL DIAL MISS DIG @ 811 FOR PROTECTION OF UNDER GROUND UTILITIES AND IN CONFORMANCE WITH PUBLIC ACT 174 OF 2013 A MINIMUM OF THREE FULL WORKING DAYS, EXCLUDING SATURDAYS, SUNDAYS AND HOLIDAYS PRIOR TO BEGINNING EACH EXCAVATION IN AREAS WHERE PUBLIC UTILITIES HAVE NOT BEEN PREVIOUSLY LOCATED. MEMBERS WILL THUS BE ROUTINELY NOTIFIED. THIS DOES NOT RELIEVE THE CONTRACTOR OF THE RESPONSIBILITY OF NOTIFYING UTILITY OWNERS WHO MAY NOT BE A PART OF THE "MISS DIG" ALERT SYSTEM.

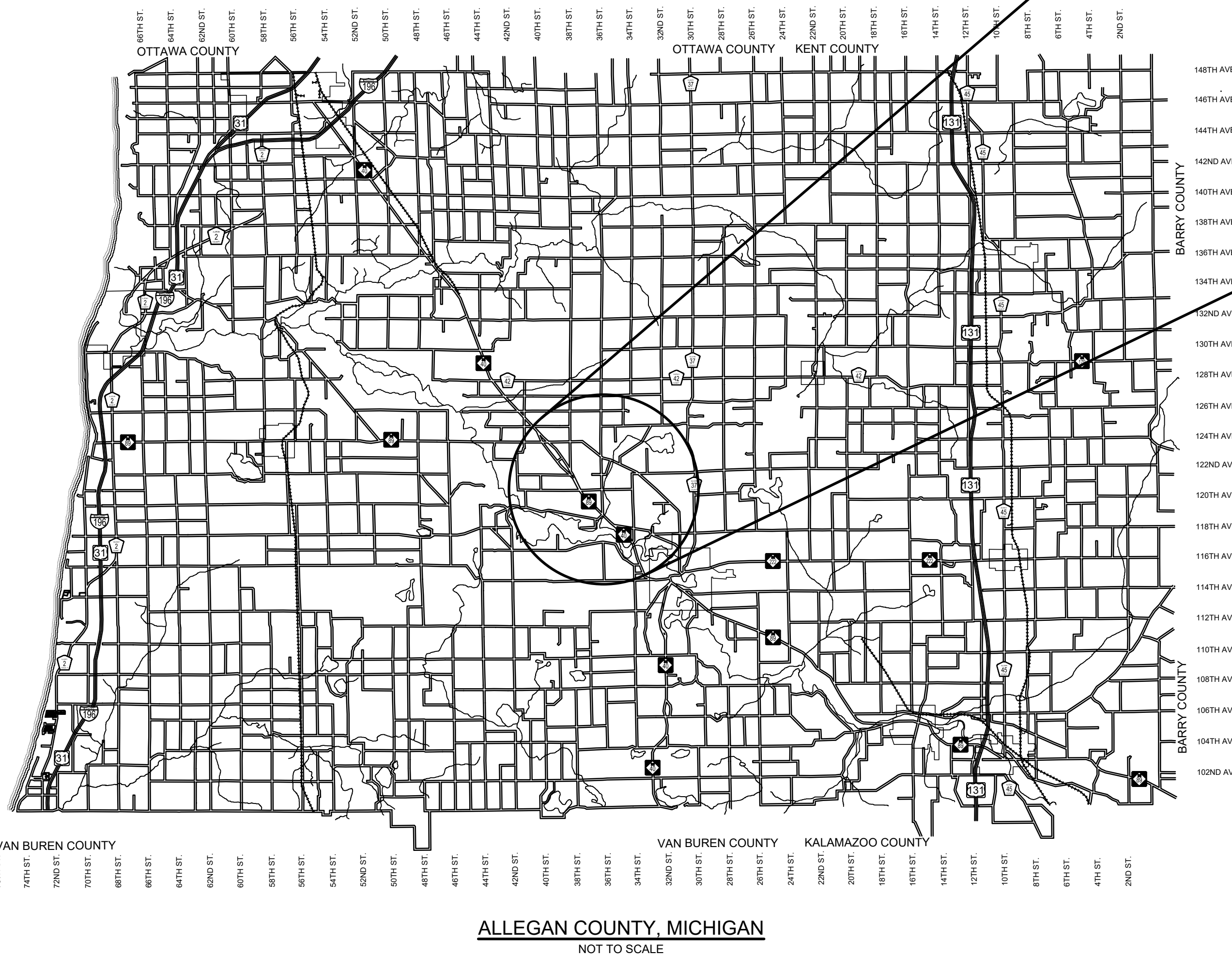
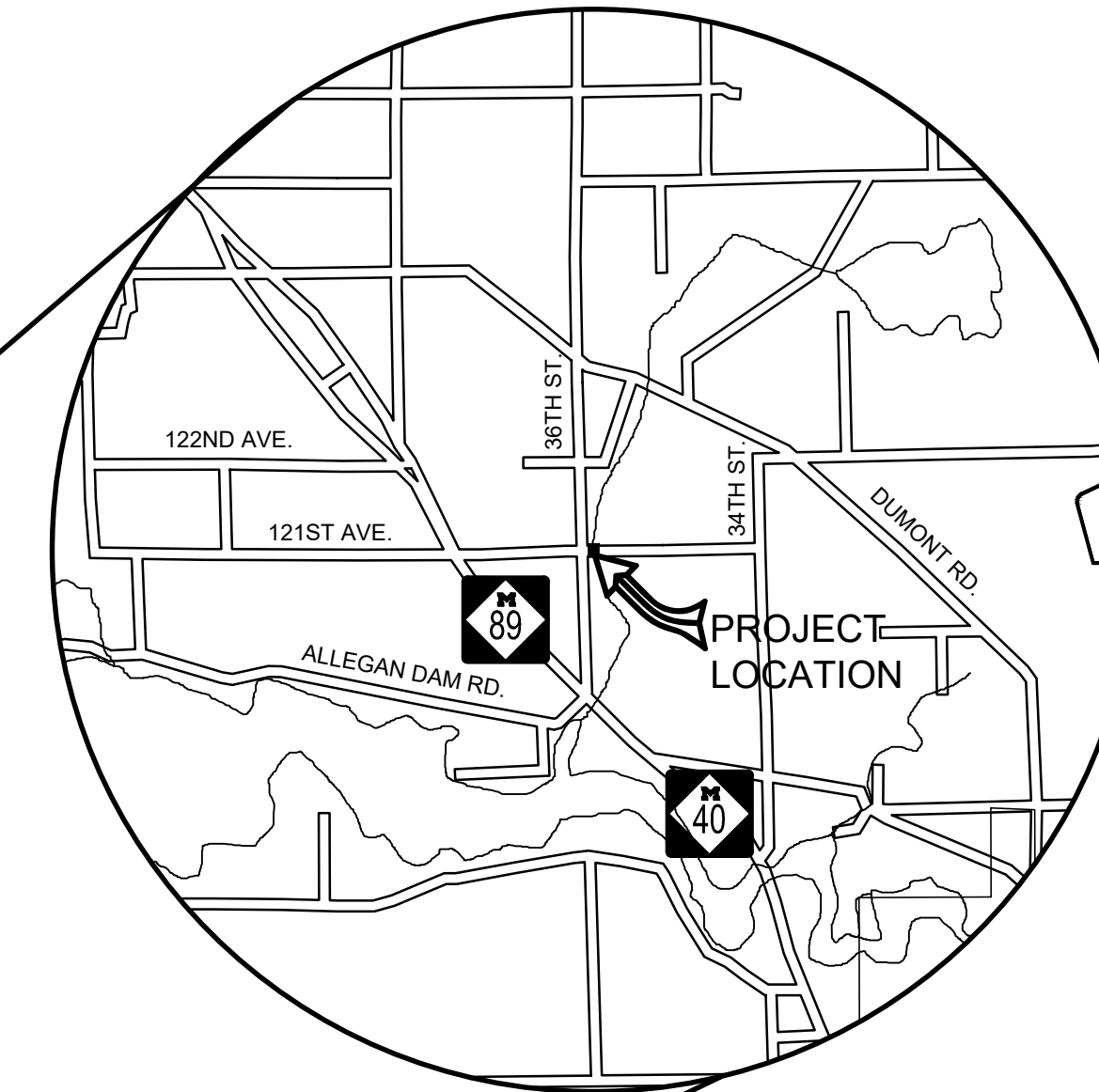

- INDEX OF PLANS**
- 1 - COVER SHEET
 - 2 - TYPICAL SECTIONS, DETAILS, & NOTES
 - 3 - 121ST AVENUE PLAN & PROFILE
 - 4 - SOIL EROSION & SEDIMENTATION CONTROL PLAN AND CREEK PROFILE

| REVISIONS | |
|-----------|--|
| 1 | |
| 2 | |
| 3 | |
| 4 | |
| 5 | |
| 6 | |
| 7 | |

121ST AVENUE CULVERT REPLACEMENT
ALLEGAN TOWNSHIP - 420 FEET EAST OF 36TH STREET

COVER SHEET

CONTRACT FOR ROAD IMPROVEMENTS
CULVERT REPLACEMENT INCLUDING CLEARING, GRADE ESTABLISHMENT, SAND SUBBASE, AGGREGATE BASE, HMA PAVING, GUARDRAIL RECONSTRUCTION, AND RESTORATION ON 121ST AVENUE APPROXIMATELY 420 FEET EAST OF 36TH STREET IN ALLEGAN TOWNSHIP, ALLEGAN COUNTY.

PREPARED UNDER THE SUPERVISION OF:

STATE OF MICHIGAN

REBEKKAH AUSBURY

No. 67389

LICENSED PROFESSIONAL ENGINEER

Rebekkah Ausbury 10/10/23

REBEKKAH K. AUSBURY
REGISTERED PROFESSIONAL ENGINEER
No. 6201067389

DRAWN BY: RKA
REVIEWED BY: RK
DATE: AUGUST 2023
SCALE: NONE

LH 400095 1

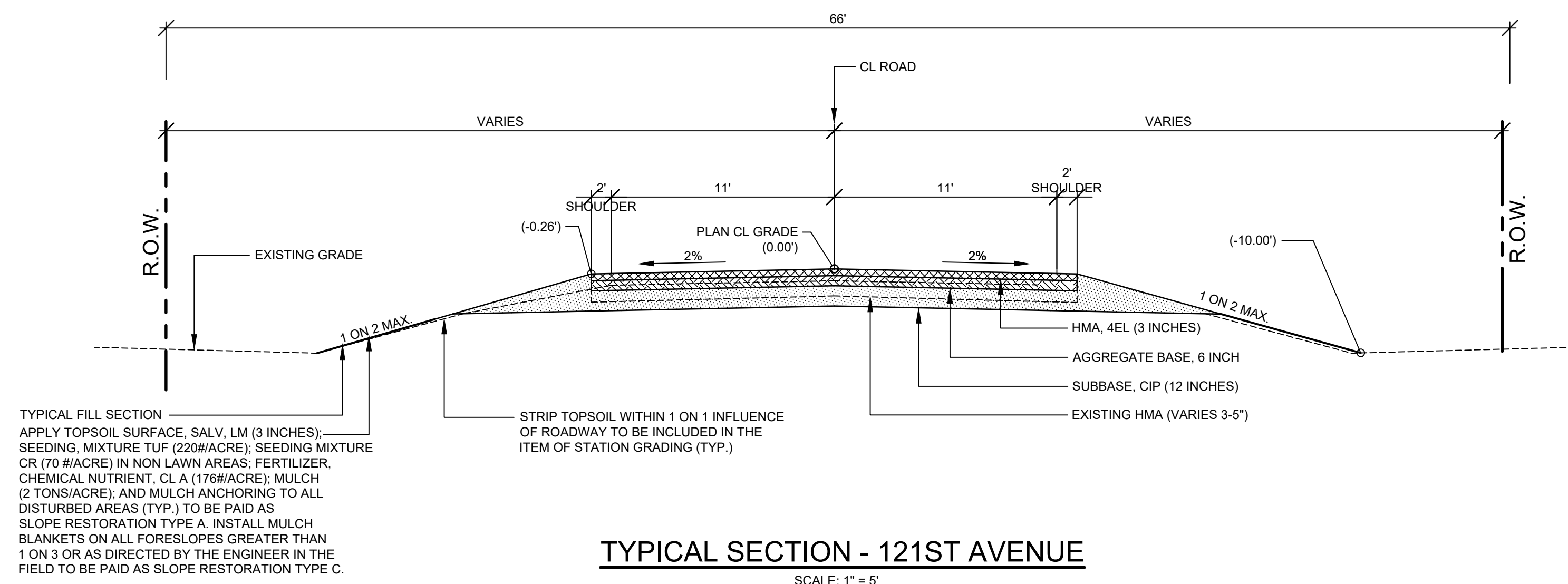

TYPICAL SECTION - 121ST AVENUE
SCALE: 1" = 5'

TYPICAL FILL SECTION
APPLY TOPSOIL SURFACE, SALV. LM (3 INCHES); SEEDING, MIXTURE TUF (220#/ACRE); SEEDING MIXTURE CR (70 #/ACRE) IN NON LAWN AREAS; FERTILIZER, CHEMICAL NUTRIENT, CL A (176#/ACRE); MULCH (2 TONS/ACRE); AND MULCH ANCHORING TO ALL DISTURBED AREAS (TYP.) TO BE PAID AS SLOPE RESTORATION TYPE A. INSTALL MULCH BLANKETS ON ALL SLOPES GREATER THAN 1 ON 3 OR AS DIRECTED BY THE ENGINEER IN THE FIELD TO BE PAID AS SLOPE RESTORATION TYPE C.

STRIP TOPSOIL WITHIN 1 ON 1 INFLUENCE OF ROADWAY TO BE INCLUDED IN THE ITEM OF STATION GRADING (TYP.)

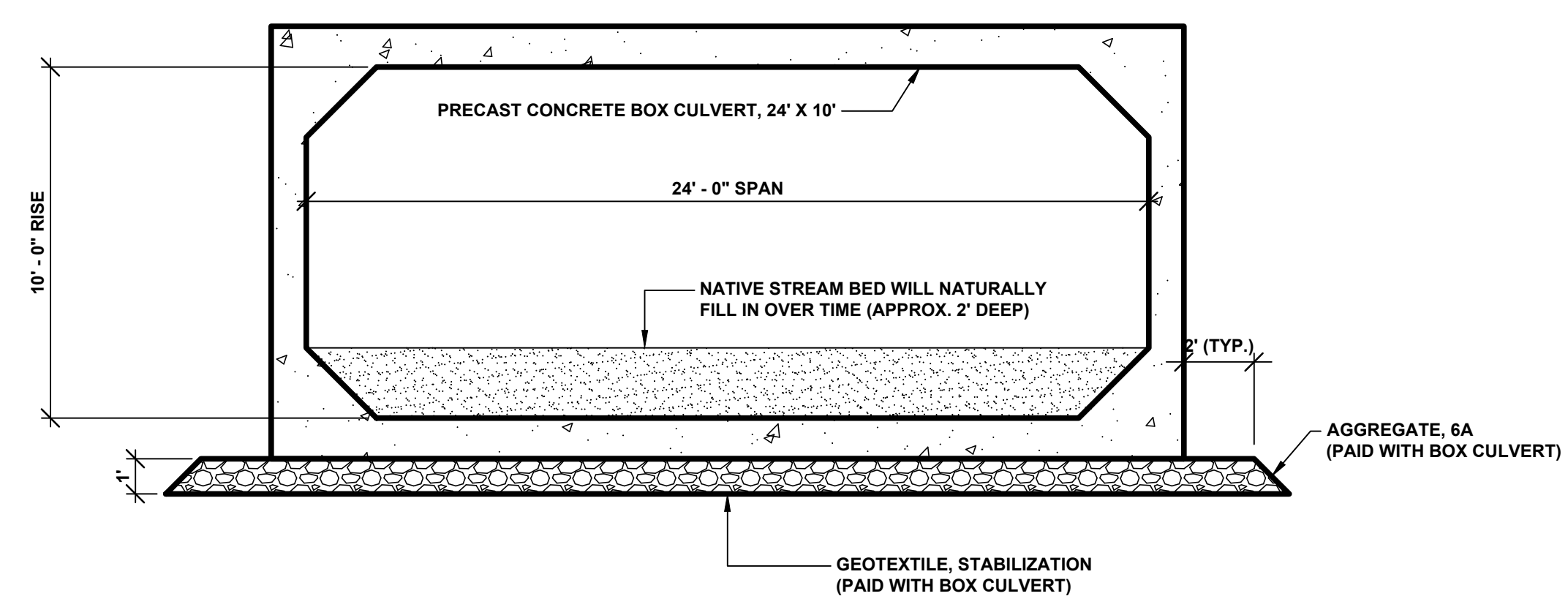

SECTION A - A
SCALE 1" = 4'

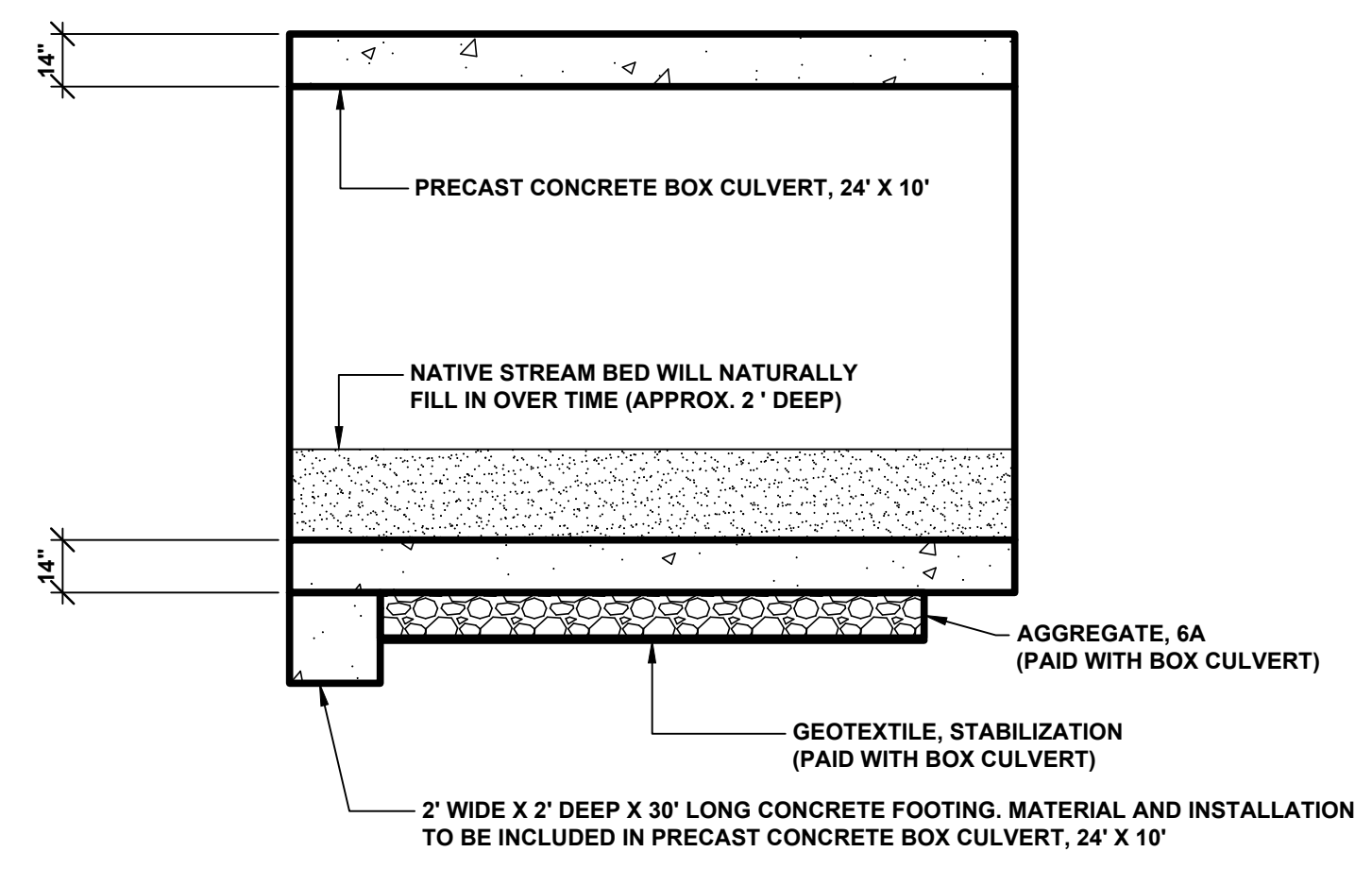

SECTION B-B
SCALE 1" = 4'

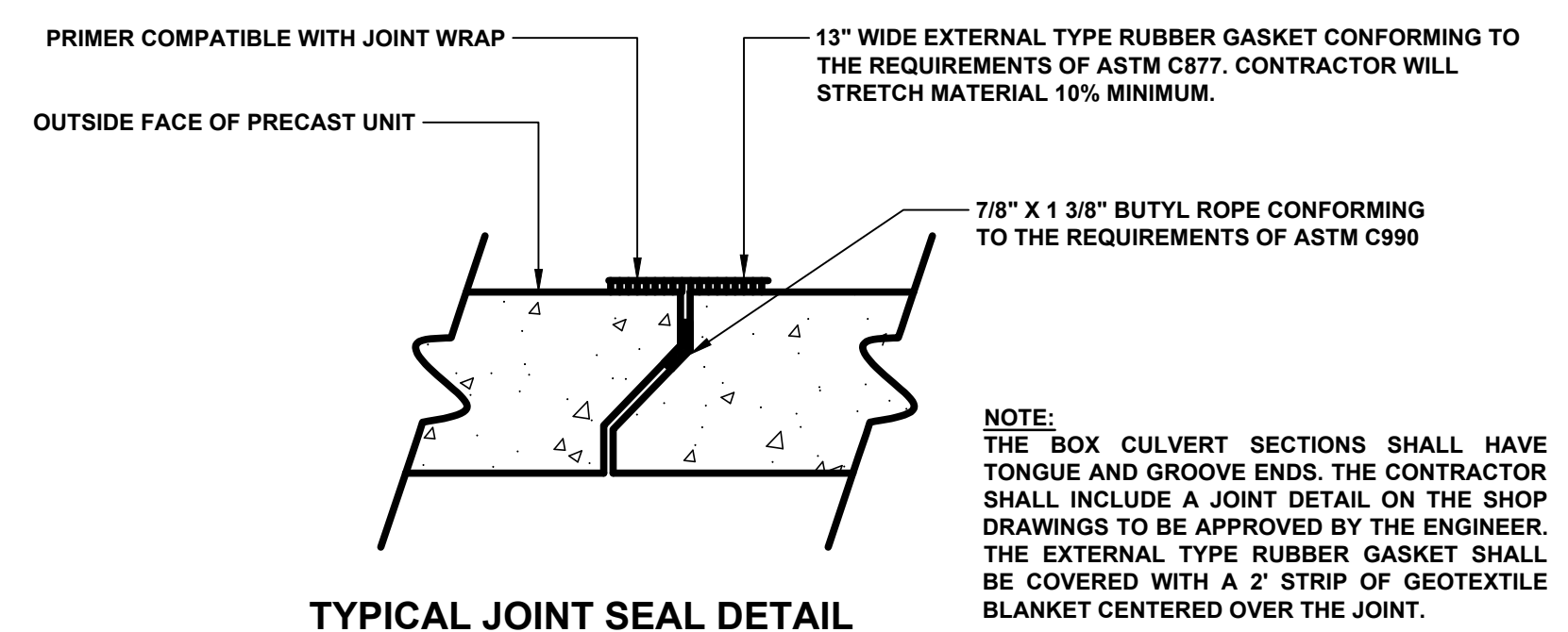

TYPICAL JOINT SEAL DETAIL

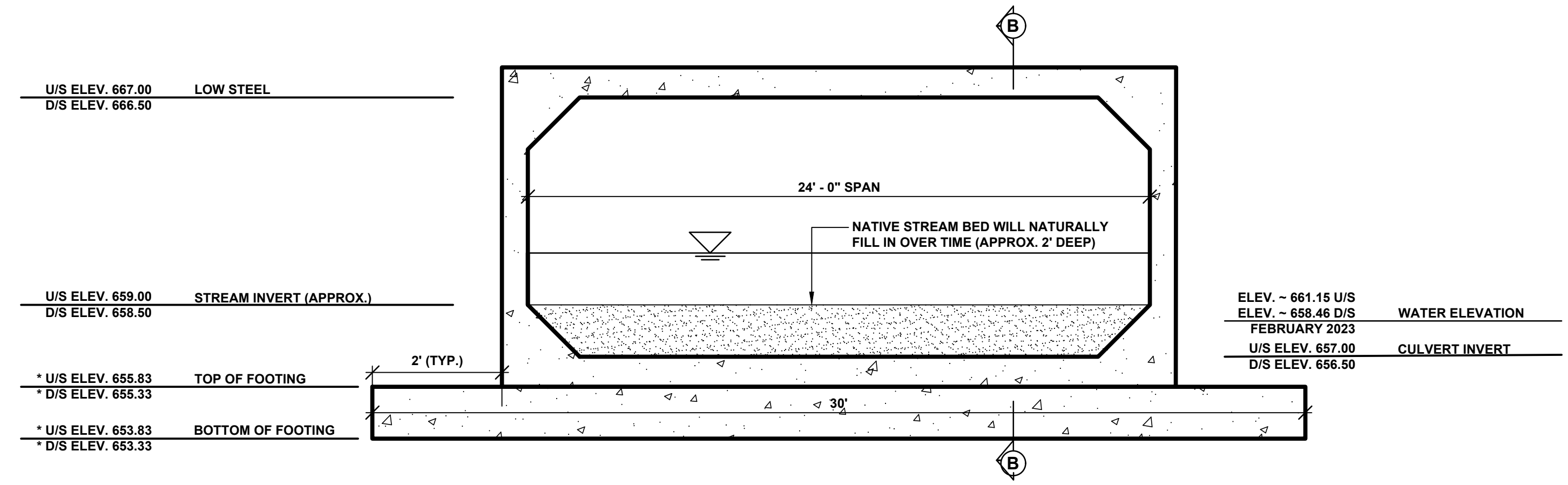

TYPICAL INLET AND OUTLET SECTION
SCALE 1" = 4'

* NOTE:
INVERT ELEVATION OF BOX CULVERT GOVERNS. TOP OF FOOTING & BOTTOM OF FOOTING ELEVATIONS MAY VARY BASED UPON THE MANUFACTURER'S CULVERT DESIGN. CONTRACTOR IS RESPONSIBLE FOR ADJUSTING THE FOOTING ACCORDINGLY.

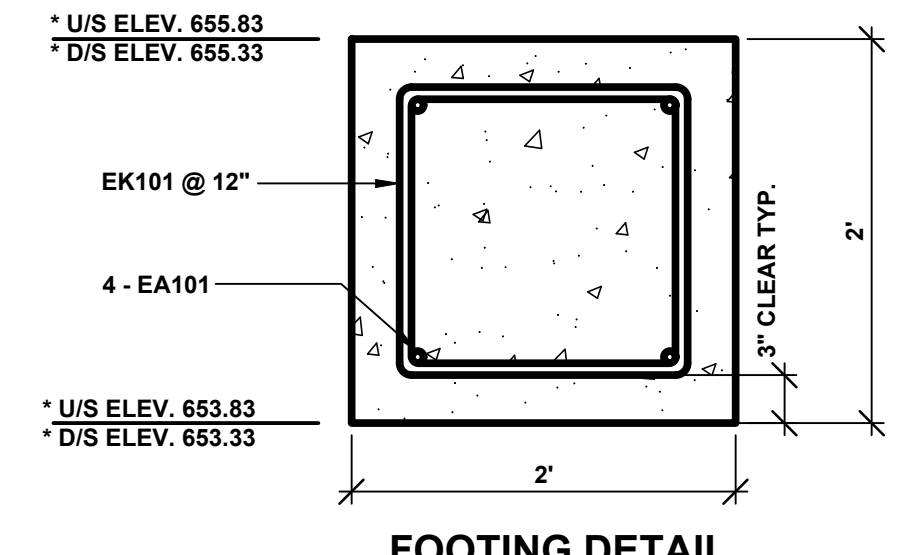

FOOTING DETAIL
SCALE 1" = 1'

| STEEL REINFORCEMENT SCHEDULE | | | | | | | | |
|------------------------------|----------|---------|---------|---------|------|----------|--------------|--------------|
| BAR | a | b | c | d | SIZE | LENGTH | NO. REQUIRED | TOTAL WEIGHT |
| EA101 | 29' - 6" | | | | #6 | 29' - 6" | 8 | 354 |
| EK101 | 1' - 6" | 1' - 0" | 1' - 0" | 1' - 6" | #6 | 6' - 6" | 62 | 605 |

NOTES:
ALL RIGHT ANGLE BENDS IN REINFORCING STEEL TO BE MADE ABOUT A PIN OF THE MINIMAL DIAMETER ALLOWED BY THE STANDARD SPECIFICATIONS.

THE CONTRACTOR IS RESPONSIBLE FOR CHECKING THE ABOVE REINFORCING STEEL QUANTITIES AND LENGTHS PRIOR TO ORDERING DELIVERY OF STEEL.

STEEL REINFORCEMENT WITH BAR DESIGNATIONS BEGINNING WITH THE LETTER "E" WILL BE EPOXY COATED.

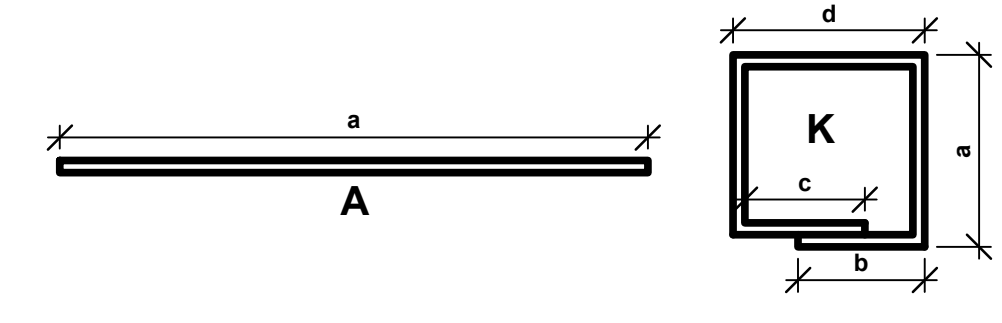

PROJECT NOTES

THE "2020 STANDARD SPECIFICATIONS FOR CONSTRUCTION" AND "STANDARD PLANS" BY THE MICHIGAN DEPARTMENT OF TRANSPORTATION (MDOT) ARE HEREBY INCORPORATED INTO THESE CONTRACT DOCUMENTS. COPIES OF THESE STANDARDS ARE AVAILABLE FOR INSPECTION AT THE OFFICE OF THE ENGINEER.

THE CONTRACTOR WILL BE RESPONSIBLE FOR CONTACTING THE ALLEGAN COUNTY ROAD COMMISSION TO NOTIFY THEM THAT WORK IS COMMENCING AT LEAST ONE WEEK PRIOR TO CONSTRUCTION. THE ALLEGAN COUNTY ROAD COMMISSION WILL SET UP THE NECESSARY DETOUR ROUTE. THE CONTRACTOR WILL BE RESPONSIBLE FOR PROVIDING THE BARRICADES.

THE CONTRACTOR SHOULD NOTE THAT STATION GRADING WILL INCLUDE THE REMOVAL OF FENCES, CULVERTS, BRUSH, TREES SMALLER THAN 6", CONCRETE FOUNDATIONS, GUARDRAIL, AND MISCELLANEOUS ITEMS AS REQUIRED AND WILL ALSO INCLUDE ALL EARTH EXCAVATION, EMBANKMENT, AND ALL OTHER OPERATIONS NECESSARY TO DEVELOP THE DESIRED CROSS SECTION. ALL TOPSOIL AND OTHER UNSUITABLE MATERIAL LOCATED BENEATH THE PROPOSED PAVEMENT SECTION WILL BE REMOVED TO THE SUBGRADE ELEVATION AS PART OF STATION GRADING. ALL TOPSOIL REMOVED MAY BE STOCKPILED AND REUSED AS TOPSOIL SURFACE, SALV. LM.

ALL FILL FOR THIS PROJECT MUST BE OBTAINED AND FURNISHED BY THE CONTRACTOR. ALL REQUIRED FILL SHALL BE SELECTED EXCAVATED MATERIAL FROM THE SITE APPROVED BY THE ENGINEER, OR MDOT CLASS II GRANULAR MATERIAL FROM BORROW. EXCESS FILL WILL BE REMOVED FROM SITE BY THE CONTRACTOR. NO BORROW OR SOIL REMOVAL ARRANGEMENTS HAVE BEEN PREARRANGED FOR THIS PROJECT AND WILL BE THE TOTAL RESPONSIBILITY OF THE CONTRACTOR.

THE ITEM OF SUBBASE, CIP WILL BE PAID FOR AT PLAN QUANTITY EXCEPT IN THE CASE OF A DESIGN CHANGE OR DEMONSTRATED ERROR.

ALL DISTURBED AREAS NOT TO BE PAVED WILL BE RESTORED WITH TOPSOIL SURFACE, SALV. LM (3 INCHES); MDOT SEED MIXTURE TUF (220#/ACRE); SEEDING MIXTURE CR (70 #/ACRE) IN NON LAWN AREAS; FERTILIZER, CHEMICAL NUTRIENT, CL A (176#/ACRE); AND MULCH AND MULCH ANCHORING (2 TONS/ACRE) TO BE PAID AS SLOPE RESTORATION, TYPE A. SEE SESC PLAN FOR AREAS TO USE HIGH VELOCITY MULCH BLANKET, TO BE PAID AS SLOPE RESTORATION TYPE C.

ADEQUATE DUST CONTROL MEASURES WILL BE MAINTAINED BY THE CONTRACTOR AS DIRECTED BY THE ENGINEER IN THE FIELD, TO BE INCLUDED IN THE VARIOUS ITEMS OF WORK.

THE CONTRACTOR IS RESPONSIBLE FOR MAINTAINING EXISTING DRAINAGE PATTERNS, AND WILL RESOLVE ANY DRAINAGE PROBLEMS ON ADJACENT PROPERTIES WHICH MAY RESULT FROM THE CONTRACTOR'S ACTIVITIES.

DATUM REFERS TO NAVD88 DATUM.

DIMENSIONS TAKE PRECEDENCE OVER SCALE. CONTRACTOR TO VERIFY ALL DIMENSIONS IN FIELD.

UTILITY NOTES

FOR PROTECTION OF UNDERGROUND UTILITIES AND IN CONFORMANCE WITH PUBLIC ACT 174 OF 2013, THE CONTRACTOR WILL CONTACT "MISS DIG" AT 811, A MINIMUM OF 72 HOURS, EXCLUDING SATURDAYS, SUNDAYS, AND HOLIDAYS, PRIOR TO BEGINNING EACH EXCAVATION IN AREAS WHERE PUBLIC UTILITIES HAVE NOT BEEN PREVIOUSLY LOCATED. MEMBERS WILL BE ROUTINELY NOTIFIED. THIS DOES NOT RELIEVE THE CONTRACTOR OF THE RESPONSIBILITY OF NOTIFYING UTILITY OWNERS WHO MAY NOT BE A PART OF THE "MISS DIG" ALERT SYSTEM.

THE CONTRACTOR WILL LOCATE ALL ACTIVE UNDERGROUND UTILITIES PRIOR TO STARTING WORK AND WILL CONDUCT HIS OPERATIONS IN A MANNER AS TO ENSURE THAT THOSE UTILITIES NOT REQUIRING RELOCATION WILL NOT BE DISTURBED.

**Board of County Road Commissioners
Of Allegan County**
1308 LINCOLN ROAD
ALLEGAN, MICHIGAN 49010-9762
www.alleganroads.org FAX (269) 673-5922
TELEPHONE (269) 673-2184

| REVISIONS | | | | | | |
|-----------|------|-------------|----|------|-------|-------|
| NO. | DATE | DESCRIPTION | BY | CHKD | APP'D | SCALE |
| 1 | | | | | | |
| 2 | | | | | | |
| 3 | | | | | | |
| 4 | | | | | | |
| 5 | | | | | | |
| 6 | | | | | | |
| 7 | | | | | | |

121ST AVENUE CULVERT REPLACEMENT
ALLEGAN TOWNSHIP - 420' EAST OF 36TH STREET
TYPICAL SECTIONS, DETAILS, & NOTES

DRAWN BY: RKA
REVIEWED BY: RK
DATE: AUGUST 2023
SCALE: AS NOTED

LH 400095 2



01-007-008-00
DEKOTA TATROW
2107 36TH STREET
ALLEGAN, MI 49010

01-007-009-00
KYLE HARNDEN TRUST
3555 121ST AVENUE
ALLEGAN, MI 49010

01-007-011-02
AARON & JANE SKOMIAL
2095 36TH STREET
ALLEGAN, MI 49010

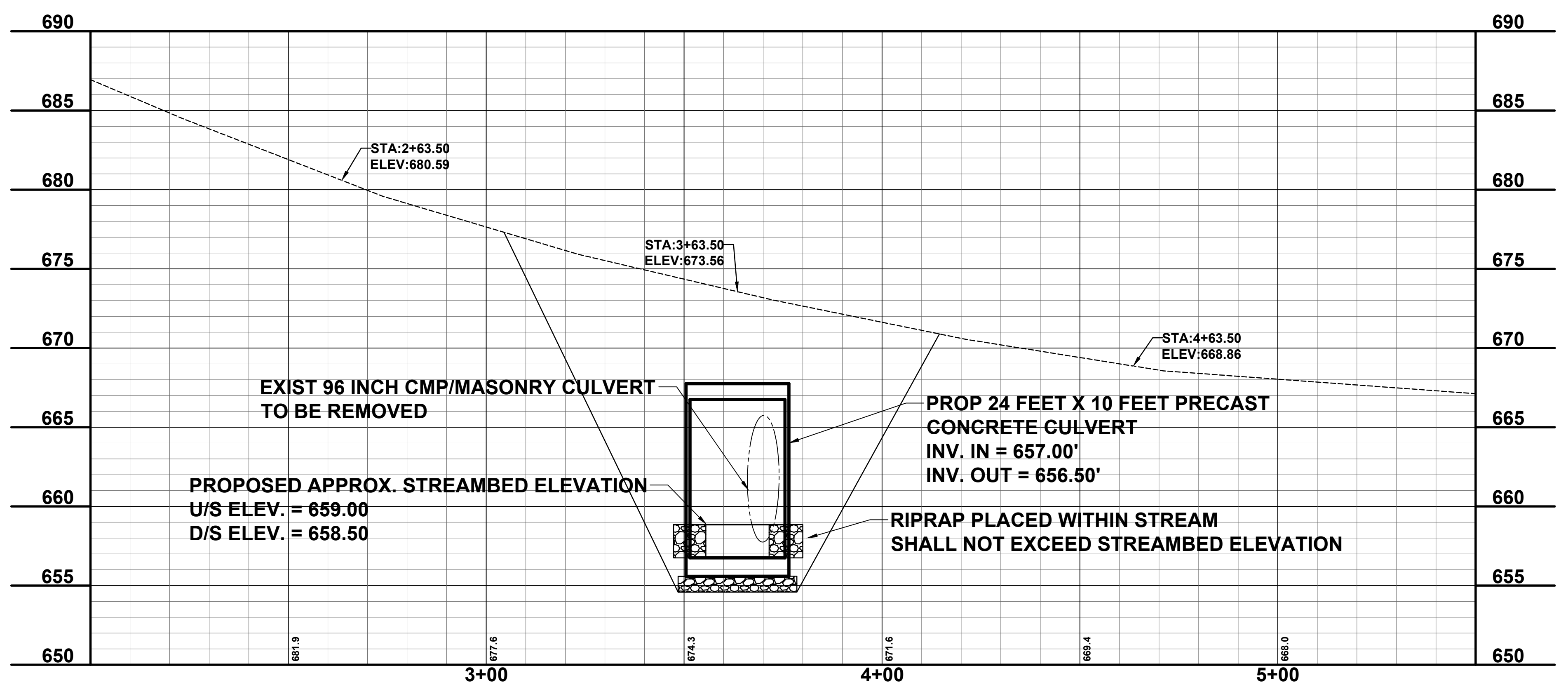
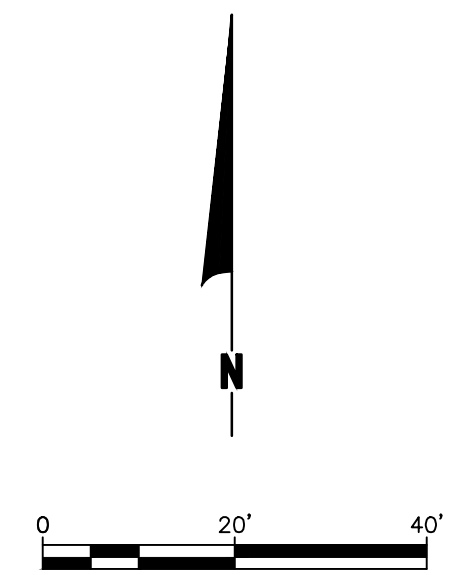
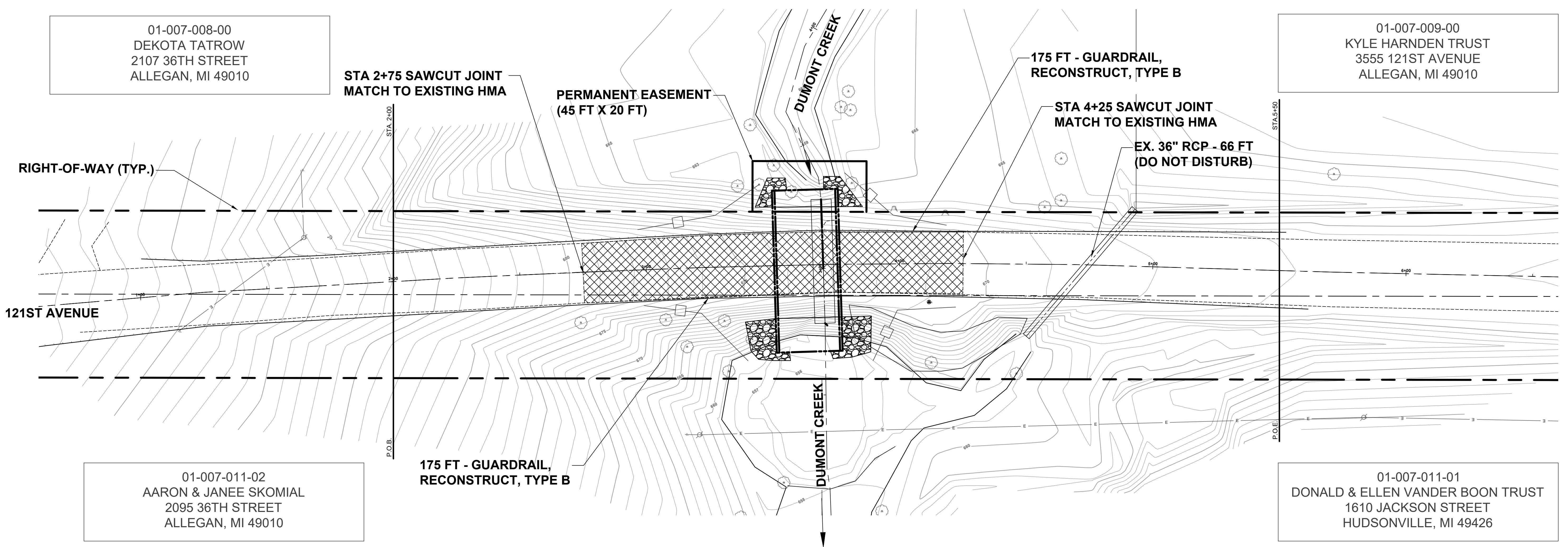
01-007-011-01
DONALD & ELLEN VANDER BOON TRUST
1610 JACKSON STREET
HUDSONVILLE, MI 49426



- LEGEND**
-  RIPRAP, AS DIRECTED BY THE ENGINEER IN THE FIELD, PAID FOR AS RIPRAP, HEAVY BY THE SYD.
 -  SAWCUT AND REMOVE EXISTING HMA PAVEMENT, REGRADE EXISTING ROAD BASE AS REQUIRED AND SURFACE WITH 4EL: 165#/SYD HMA, 4EL (LEVELING); AND 165#/SYD HMA, 4EL (TOP).

**Board of County Road Commissioners
Of Allegan County**
1308 LINCOLN ROAD
ALLEGAN, MICHIGAN 49010-9762
TELEPHONE (269) 673-2184 www.alleganroads.org FAX (269) 673-5922

| REVISIONS | |
|-----------|--|
| 1 | |
| 2 | |
| 3 | |
| 4 | |
| 5 | |
| 6 | |
| 7 | |

121ST AVENUE CULVERT REPLACEMENT
ALLEGAN TOWNSHIP - 420' EAST OF 36TH STREET
121ST AVENUE PLAN & PROFILE

DRAWN BY: RKA
REVIEWED BY: RK
DATE: AUGUST, 2023
SCALE: 1"= 20'H, 5'V

LH 400012 3

01-007-011-02
 AARON & JANE SKOMIAL
 2095 36TH STREET
 ALLEGAN, MI 49010

01-007-008-00
 DEKOTA TATROW
 2107 36TH STREET
 ALLEGAN, MI 49010

40 SYD - RIPRAP, HEAVY
 APPROX. 15' X 10' EACH SIDE OF OUTLET
 RIPRAP PLACED WITHIN
 STREAM SHALL NOT EXCEED
 ELEVATION 658.5

20 SYD - RIPRAP, HEAVY
 APPROX. 12' X 5' EACH SIDE OF INLET
 RIPRAP PLACED WITHIN STREAM
 SHALL NOT EXCEED ELEVATION
 659.0

EX. 50 FT - CULV, 96 INCH
 (TO BE REMOVED)

PERMANENT EASEMENT
 (45 FT X 20 FT)

EX. 36" RCP - 66 FT
 (DO NOT DISTURB)

PLACE VARIOUS WIDTHS OF HIGH
 VELOCITY MULCH BLANKET TO COVER
 SLOPE FROM STA. 2+75 TO 4+25
 (PAID AS SLOPE RESTORATION TYPE C)

01-007-011-01
 DONALD & ELLEN VANDER BOON TRUST
 1610 JACKSON STREET
 HUDSONVILLE, MI 49426

01-007-009-00
 KYLE HARNDEN TRUST
 3555 121ST AVENUE
 ALLEGAN, MI 49010

SOIL EROSION & SEDIMENTATION CONTROL NOTES

- ALL CONSTRUCTION METHODS WILL BE DONE IN COMPLIANCE WITH THE MICHIGAN SOIL EROSION AND SEDIMENTATION CONTROL ACT. THE CONTRACTOR WILL BE RESPONSIBLE FOR OBTAINING A "SOIL EROSION PERMIT" FROM THE COUNTY AND/OR A "PERMIT BY RULE/NOTICE OF COVERAGE" FROM THE MDEQ PRIOR TO START OF CONSTRUCTION. THE CONTRACTOR WILL BE RESPONSIBLE FOR COMPLYING WITH ALL REQUIREMENTS OF THE COUNTY "SOIL EROSION PERMIT" AND FOR ALL CERTIFIED STORM WATER INSPECTION SERVICE REQUIRED BY THE "PERMIT BY RULE". EROSION CONTROL MEASURES SHOWN ON THE PLANS ARE THE MINIMUM REQUIREMENTS AND WILL NOT RELIEVE THE CONTRACTOR'S RESPONSIBILITY FOR PROVIDING ALL REQUIRED EROSION CONTROL MEASURES.
- AVOID UNNECESSARY DISTURBING OR REMOVING OF EXISTING VEGETATED TOPSOIL OR EARTH COVER. THESE COVER AREAS ACT AS SEDIMENT FILTERS.
- ALL TEMPORARY SOIL EROSION PROTECTION WILL REMAIN IN PLACE UNTIL REMOVAL IS REQUIRED FOR FINAL CLEAN UP AND APPROVAL.
- GEOTEXTILE SILT FENCE WILL BE INSTALLED AS REQUIRED WHEN CROSSING CREEKS OR WHEN ADJACENT TO WETLANDS OR SURFACE WATER BODIES TO PREVENT SILTATION AND ELSEWHERE AS DIRECTED BY THE ENGINEER. SEEDING AND/OR SODDING WILL BE INSTALLED ON CREEK BANKS IMMEDIATELY AFTER CONSTRUCTION TO PREVENT EROSION.
- MAINTENANCE, CLEANING, AND REMOVAL OF THE VARIOUS SEDIMENT CONTROL MEASURES WILL BE INCLUDED IN THE VARIOUS EROSION CONTROL ITEMS.
- SOIL TYPE LOCATIONS ARE APPROXIMATED FROM THE UNITED STATES DEPARTMENT OF AGRICULTURE'S WEB SOIL SURVEY MAPS. DETAILED PROPERTIES FOR EACH SOIL TYPE CAN BE FOUND ON THEIR WEBSITE: WEBSOILSURVEY.NRCS.USDA.GOV
- TEMPORARY EROSION CONTROL MEASURES WILL NOT BE MANDATORY IF STORMWATER IS DETERMINED TO BE TOPOGRAPHICALLY INCAPABLE OF LEAVING SITE.
- SLOPE STAKE LINES AS CALLED OUT IN THE PLAN SHEETS DEFINE THE EARTH CHANGE LIMITS FOR THIS PROJECT.
- ALLEGAN COUNTY ROAD COMMISSION ASSUMES RESPONSIBILITY FOR MAINTENANCE OF PERMANENT SOIL EROSION & SEDIMENTATION CONTROL MEASURES ONE YEAR AFTER FINAL PROJECT ACCEPTANCE AS DEFINED UNDER THE SOIL EROSION AND SEDIMENTATION CONTROL OPERATING PROCEDURES FOR THE ALLEGAN COUNTY ROAD COMMISSION.

- # NUMBER IN CIRCLE REFERS TO NUMBERED DETAILS ON MDOT STANDARD PLAN R-96 SERIES. SOIL EROSION & SEDIMENTATION CONTROL MEASURES. "P" DENOTES PERMANENT MEASURE AND "T" DENOTES TEMPORARY MEASURE. SOIL EROSION CONTROL PLANS DENOTE MINIMUM EROSION MEASURES REQUIRED AS DESCRIBED BELOW.
- 3P ALL DISTURBED AREAS NOT PAVED OR GRAVELED SHALL BE RESTORED UNDER THE PAY ITEM SLOPE RESTORATION TYPE A. THIS PAY ITEM INCLUDES PLACING MDOT SEEDING, MIXTURE TUF APPLIED AT A RATE OF 220 LB/ACRE, FERTILIZER, CHEMICAL NUTRIENT, CL A APPLIED AT A RATE OF 176 LB/ACRE; MULCH AT A RATE OF 2 TON/ACRE AND MULCH ANCHORING.
- 3T TEMPORARY SEEDING WILL BE PLACED AT LOCATIONS DETERMINED BY THE ENGINEER IN THE FIELD AND WILL INCLUDE SEEDING MIXTURE, CR APPLIED AT A RATE OF 70 LB/ACRE AND MULCH INCLUDED IN SLOPE RESTORATION TYPE A.
- 4T DUST CONTROL MAY BE REQUIRED ON THE SUBGRADE CONSTRUCTION AND WILL INCLUDE APPLYING FRESH WATER TO BE INCLUDED IN THE ITEM OF STATION GRADING. DUST CONTROL ON THE AGGREGATE BASE COURSE WILL BE ACCOMPLISHED BY APPLYING FRESH WATER (INCLUDED IN THE ITEM OF AGGREGATE BASE, INCH) AS DIRECTED BY THE PROJECT ENGINEER.
- 7P INSTALL RIPRAP, PLAIN OR RIPRAP, HEAVY AS DIRECTED BY THE ENGINEER IN THE FIELD. THE RIPRAP, PLAIN AND RIPRAP, HEAVY PAY ITEMS WILL INCLUDE A GEOTEXTILE UNDERLAYMENT.
- 26T SILT FENCE WILL BE INSTALLED AT CREEK CROSSINGS, ADJACENT TO ALL WETLANDS AND SURFACE WATERS, AND OTHER LOCATIONS AS DIRECTED BY THE ENGINEER. EACH SILT FENCE WILL BE INSTALLED GENERALLY ALONG THE SAME CONTOUR ELEVATION.
- 32 CONTRACTOR WILL PROVIDE DOZER TRACKING PERPENDICULAR TO THE SLOPE TO REDUCE WATER AND WIND EROSION. THIS WILL BE PERFORMED AT LOCATIONS SHOWN OR AS DIRECTED BY THE ENGINEER IN THE FIELD, TO BE INCLUDED IN THE ITEM OF EMBANKMENT.
- 35 HIGH VELOCITY MULCH BLANKETS WILL BE USED ON STEEP BANKS. PROVIDE MULCH BLANKET, HIGH VELOCITY CENTERED ON ALL DITCH BOTTOMS WITH A LONGITUDINAL GRADE OF 2.00% OR GREATER AND AT OTHER LOCATIONS AS DIRECTED BY THE ENGINEER IN THE FIELD. PAID AS SLOPE RESTORATION TYPE C.
- 37 CHECK DAMS WILL BE INSTALLED AT THE LOCATIONS SHOWN ON THE PLAN OR AS DIRECTED BY THE ENGINEER IN THE FIELD.

| TIMING & SEQUENCE | MONTH 1 | | | MONTH 2 | | | MONTH 3 | | | | | | |
|--|---------|--------|--------|---------|--------|--------|---------|--------|--------|---------|---------|---------|---------|
| | WEEK 1 | WEEK 2 | WEEK 3 | WEEK 4 | WEEK 5 | WEEK 6 | WEEK 7 | WEEK 8 | WEEK 9 | WEEK 10 | WEEK 11 | WEEK 12 | WEEK 13 |
| ANTICIPATED START DATE: MARCH 1, 2024 | | | | | | | | | | | | | |
| INSTALL/MAINTAIN TEMPORARY CONTROL MEASURES | | | | | | | | | | | | | |
| SITE CLEARING | | | | | | | | | | | | | |
| CULVERT INSTALLATIONS | | | | | | | | | | | | | |
| ROADWAY/SLOPE RECONSTRUCTION | | | | | | | | | | | | | |
| SLOPE RESTORATION/INSTALL PERMANENT CONTROL MEASURES | | | | | | | | | | | | | |
| REMOVE TEMPORARY MEASURES | | | | | | | | | | | | | |

*SCHEDULE MAY BE ADJUSTED DEPENDING ON CONTRACTOR'S MEANS & METHODS

STAGING NOTES

- INSTALL TEMPORARY EROSION CONTROL MEASURES.
- CONSTRUCT THE TEMPORARY CREEK DIVERSION.
- REMOVE THE EXISTING 96" CORRUGATED METAL/CAST-IN-PLACE CONCRETE CULVERT STRUCTURE.
- INSTALL THE 24' X 10' PRECAST CONCRETE BOX CULVERT.
- OPEN THE CHANNEL FROM THE DOWNSTREAM END AND ALLOW THE WATER TO EQUALIZE. OPEN THE UPSTREAM SIDE OF THE NEW CHANNEL AND REMOVE THE TEMPORARY DIVERSION.
- BACKFILL THE TEMPORARY DIVERSION AND PRECAST CONCRETE BOX.
- INSTALL PERMANENT SOIL EROSION CONTROL MEASURES.

LEGEND

 RIPRAP, AS DIRECTED BY THE ENGINEER IN THE FIELD, PAID FOR AS RIPRAP, HEAVY BY THE SYD.

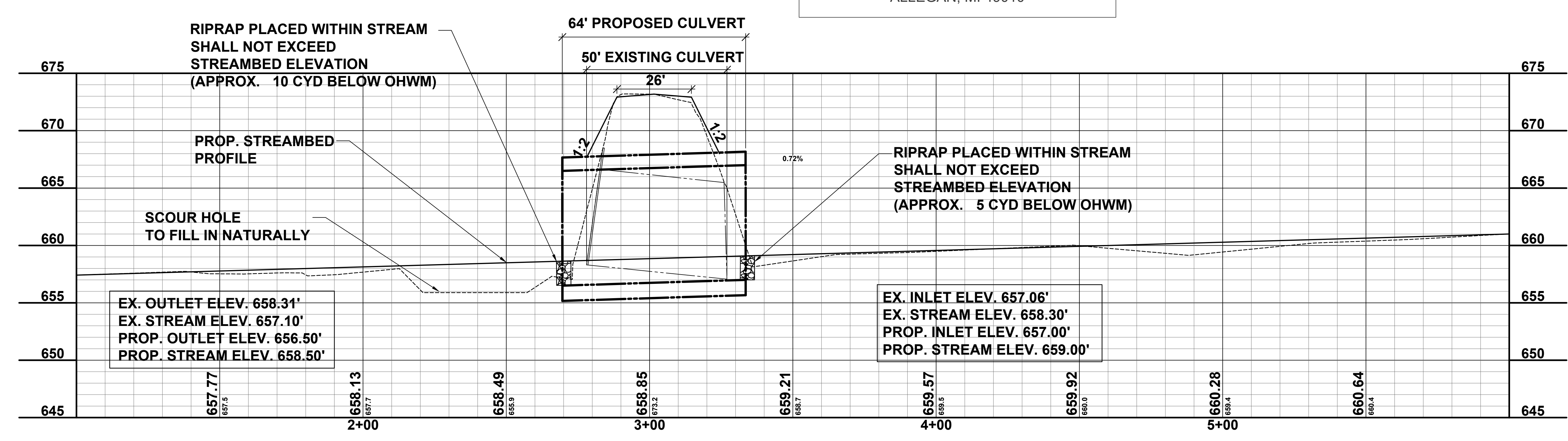
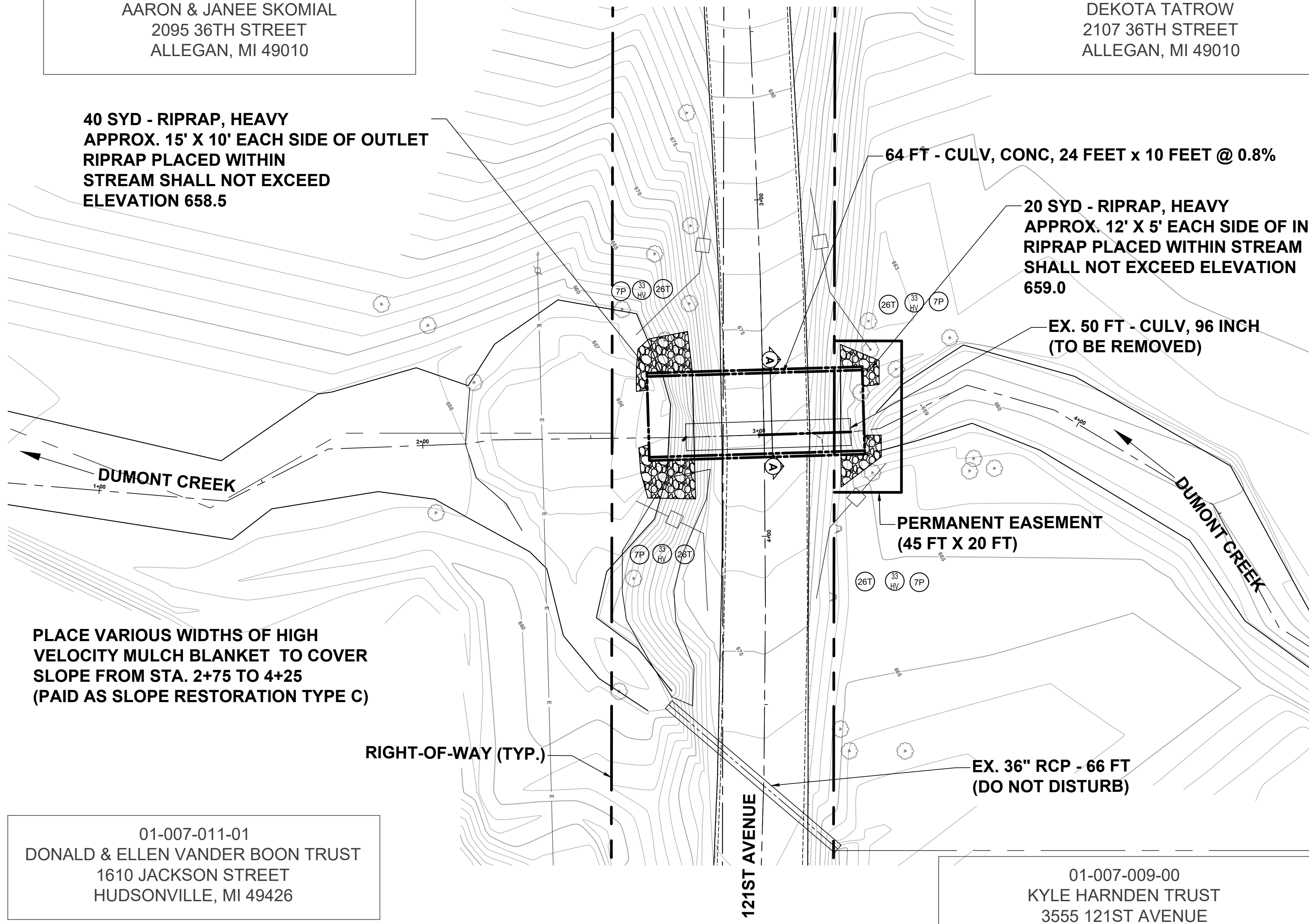

**Board of County Road Commissioners
 Of Allegan County**
 1308 LINCOLN ROAD
 ALLEGAN, MICHIGAN 49010-9762
 www.alleganroads.org
 TELEPHONE (269) 673-2184 FAX (269) 673-5922

| REVISIONS | 1 | 2 | 3 | 4 | 5 | 6 | 7 |
|-----------|---|---|---|---|---|---|---|
| | | | | | | | |

121ST AVENUE CULVERT REPLACEMENT
 ALLEGAN TOWNSHIP - 420 FEET EAST OF 36TH STREET

SOIL EROSION AND SEDIMENTATION CONTROL PLAN & CREEK PROFILE

DRAWN BY: RKA
 REVIEWED BY: RK
 DATE: AUGUST 2023
 SCALE: 1"= 20'H, 5V