

ALLEGAN COUNTY ROAD COMMISSION

132ND AVENUE RECONSTRUCTION PROJECT 28TH STREET TO 26TH STREET MONTEREY TOWNSHIP

NOTES

EXCEPT WHERE OTHERWISE INDICATED ON THESE PLANS OR IN THE PROPOSAL AND SUPPLEMENTAL SPECIFICATIONS CONTAINED THEREIN, ALL MATERIALS AND WORKMANSHIP SHALL BE IN ACCORDANCE WITH THE 2012 MICHIGAN DEPARTMENT OF TRANSPORTATION STANDARD SPECIFICATIONS FOR CONSTRUCTION.

THE PLACING OF PAVEMENT MARKINGS AND TRAFFIC CONTROL SIGNS SHALL BE DONE IN ACCORDANCE WITH THE 2011 MICHIGAN MANUAL OF UNIFORM TRAFFIC CONTROL DEVICES AS AMENDED.

THE IMPROVEMENTS COVERED BY THESE PLANS ARE IN ACCORDANCE WITH THE AMERICAN ASSOCIATION OF STATE HIGHWAY AND TRANSPORTATION OFFICIALS, 2011 EDITION; A POLICY ON GEOMETRIC DESIGN OF HIGHWAYS AND STREETS AND WITH THE GUIDELINES FOR GEOMETRIC DESIGN OF VERY LOW-VOLUME LOCAL ROADS (ADT<400), 1ST EDITION.

THE CONTRACTOR SHALL DIAL MISS DIG @ 811 FOR PROTECTION OF UNDER GROUND UTILITIES AND IN CONFORMANCE WITH PUBLIC ACT 174 OF 2013 A MINIMUM OF THREE FULL WORKING DAYS, EXCLUDING SATURDAYS, SUNDAYS AND HOLIDAYS PRIOR TO BEGINNING EACH EXCAVATION IN AREAS WHERE PUBLIC UTILITIES HAVE NOT BEEN PREVIOUSLY LOCATED. MEMBERS WILL THUS BE ROUTINELY NOTIFIED. THIS DOES NOT RELIEVE THE CONTRACTOR OF THE RESPONSIBILITY OF NOTIFYING UTILITY OWNERS WHO MAY NOT BE A PART OF THE "MISS DIG" ALERT SYSTEM.

INDEX OF PLANS

- 1 - COVER SHEET
- 2 - TYPICAL SECTIONS, DETAILS & NOTES
- 3 - PLAN AND PROFILE - STA. P.O.B. TO STA. 14+00
- 4 - PLAN AND PROFILE - STA. 14+00 TO STA. 24+00
- 5 - PLAN AND PROFILE - STA. 24+00 TO STA. 34+00
- 6 - PLAN AND PROFILE - STA. 34+00 TO STA. 44+00
- 7 - PLAN AND PROFILE - STA. 44+00 TO STA. P.O.E.
- 8 - CROSS SECTIONS - STA. 6+00 TO STA. 15+00
- 9 - CROSS SECTIONS - STA. 16+00 TO STA. 25+00
- 10 - CROSS SECTIONS - STA. 26+00 TO STA. 31+00
- 11 - CROSS SECTIONS - STA. 32+00 TO STA. 39+00
- 12 - CROSS SECTIONS - STA. 40+00 TO STA. 49+00
- 13 - CROSS SECTIONS - STA. 50+00 TO STA. 52+00
- 14 - SOIL EROSION & SEDIMENTATION CONTROL PLAN

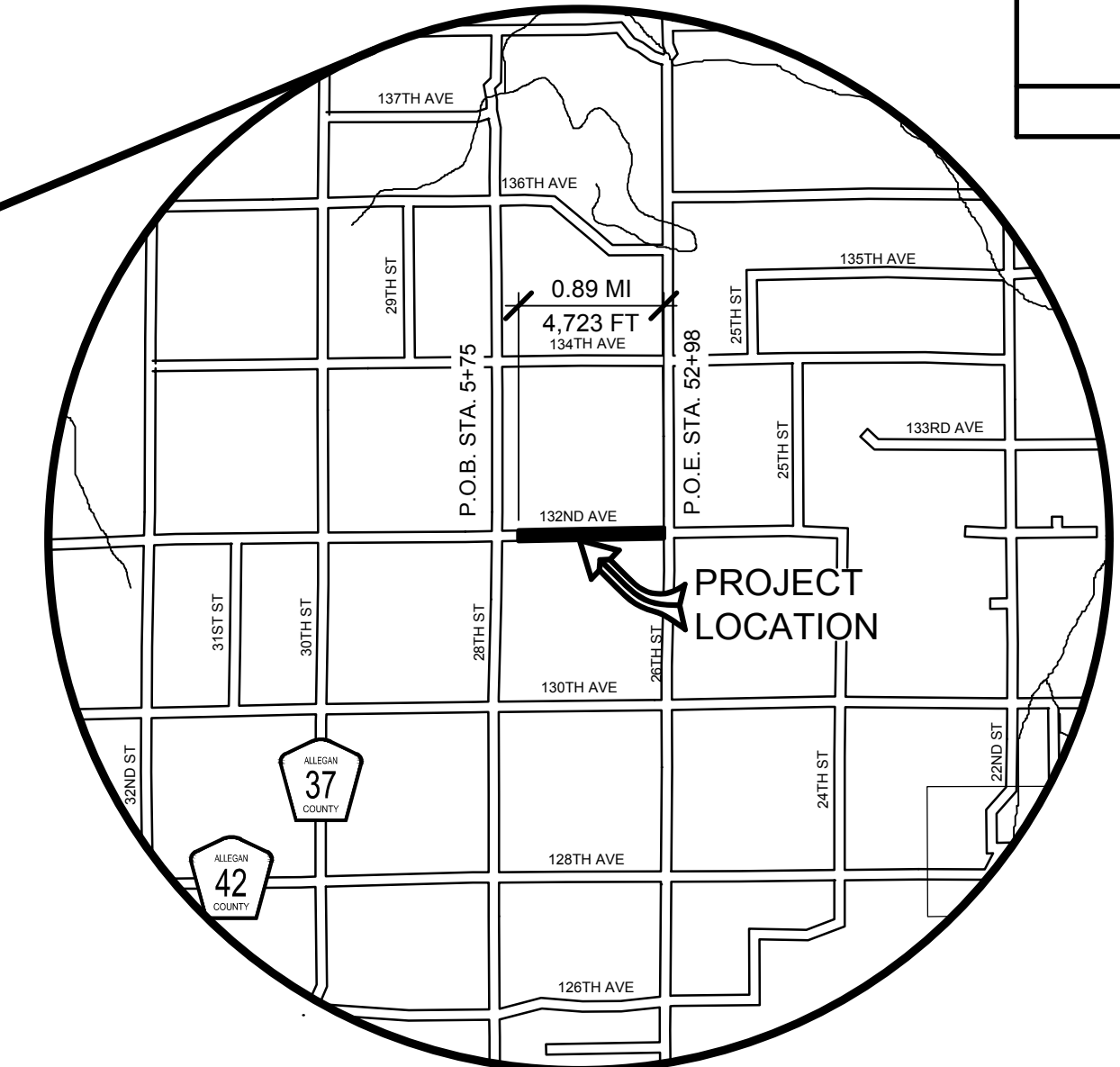
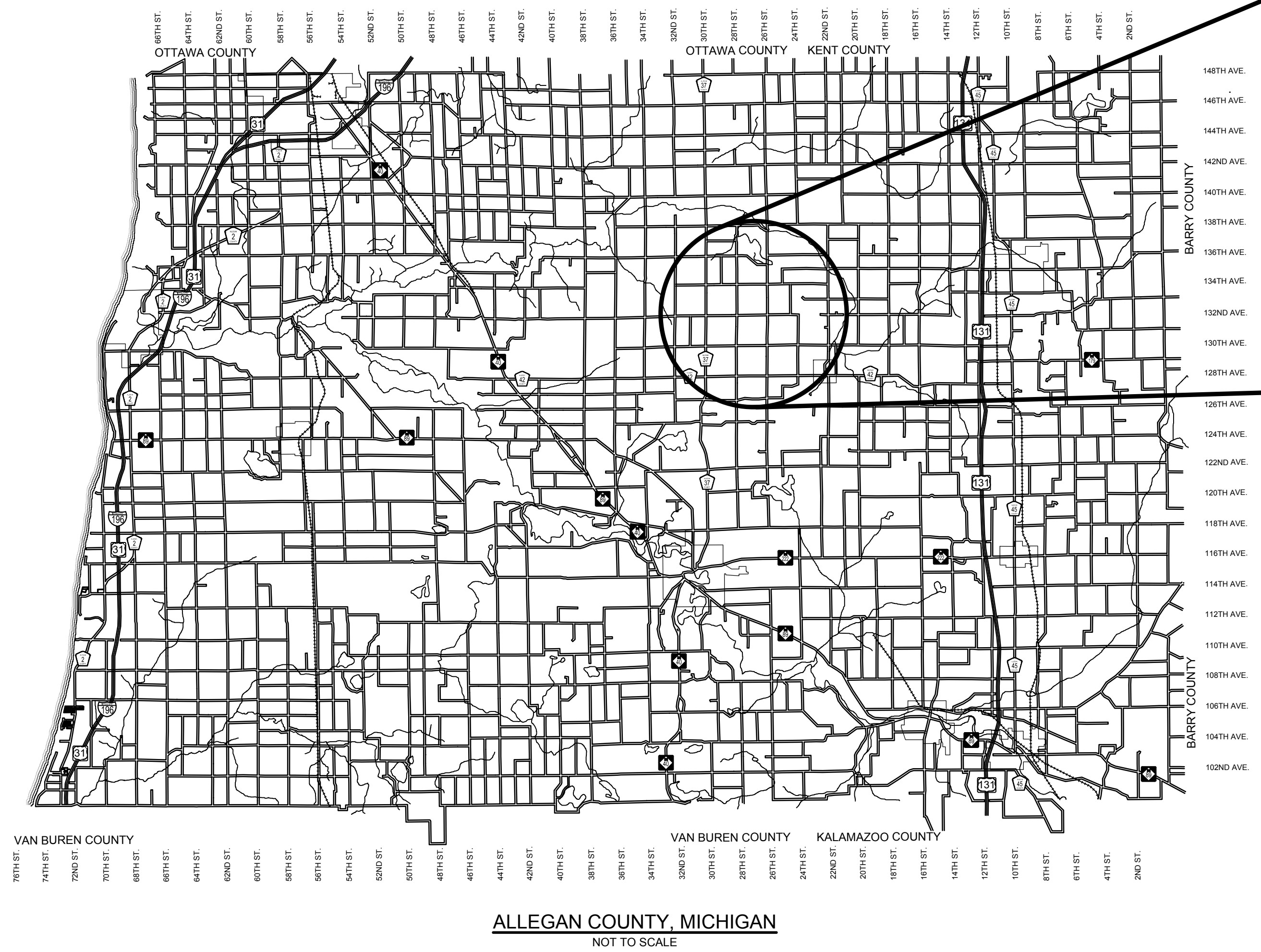

UTILITY CONTACTS

ELECTRIC
CONSUMERS ENERGY
2500 E. CORK ST
KALAMAZOO, MI 49001
269-998-6440
MR. BILL BRINDLEY
wbrindley@csmenergy.com

TELEPHONE
AT&T
955 36TH ST SE
GRAND RAPIDS, MI 49508
616-246-7302
MS. CHERYL BENNETT
cw4281@att.com

MISS DIG 811

**Board of County Road Commissioners
Of Allegan County**
1308 LINCOLN ROAD
ALLEGAN, MICHIGAN 49010-9762
TELEPHONE: (269) 673-2184 www.alleganroads.org FAX: (269) 673-5922

REVISIONS
1
2
3
4
5
6
7

132ND AVENUE RECONSTRUCTION PROJECT
MONTEREY TOWNSHIP - 28TH STREET TO 26TH STREET
COVER SHEET

CONTRACT FOR ROAD IMPROVEMENTS
0.89 MILES OF ROADWAY RECONSTRUCTION INCLUDING CLEARING, GRADE ESTABLISHMENT, SAND SUBBASE, AGGREGATE BASE, CULVERT REPLACEMENTS, AND RESTORATION ON 132ND AVENUE FROM 28TH STREET TO 26TH STREET IN MONTEREY TOWNSHIP, ALLEGAN COUNTY.

PREPARED UNDER THE SUPERVISION OF:

JASON S. EDWARDS
REGISTERED PROFESSIONAL ENGINEER No. 59473

DRAWN BY: K.W.S.
REVIEWED BY: J.S.E.
DATE: MAY, 2016
SCALE: NONE

LH 4808 1